

Knauf Silent Spacesaver

Installation Procedures

Knauf Silent Spacesaver partitions are designed to be simple and fast to install. Knauf Technical Services are on hand should you have any questions or unusual situations to deal with.

General

Knauf Silent Spacesaver partitions must be installed in accordance with Knauf's recommendations and the recommendations of BS 8212: 1995 and BS 8000: Part 8: 1994.

Perimeter Framing 1,2

Knauf 'U' Channels should be used for the head and base of the partition and to form any abutments. Bed the Knauf 'U' Channels on two continuous beads of Knauf Sealant and secure with Knauf Nailable Plugs or suitable fixings at maximum 600mm centres and 50mm from ends of channels or studs. Separate studs and channels forming the perimeter need not be joined, but should be tightly butted together.

Partitions should always run full height to the structural soffit where possible.

Vertical Studs 3,4

Knauf 'I' Studs together with the Knauf Staggered Stud Clips should be positioned within the 'U' Channel at 300mm centres and arranged to achieve a stagger from within the Knauf 'U' Channel to coincide with the abutments of the boards, which will be fixed later. In general, there is no requirement to secure the metal at this point as this will be achieved once the boards are screw-fixed.

Knauf 'I' Studs should be trimmed to within 5mm of the slab to soffit height.

Insulation 5

Once the studs have been located in the Knauf 'U' Channel and one side has been boarded, the insulation can be fitted either between the studs or wound through the studs depending on thickness. Care should be taken to ensure that the insulation is fitted neatly without gaps at abutments or horizontally between different rolls. See detail 07 on page 57 for alternative insulation installation options.

Boarding 6

All boards should be offered up to the frame with the face of the board outwards. The inner layer of boards should be offered up to the frame and fixed with Knauf Self Drilling or Jackpoint Self Drilling Screws (ensuring 10mm penetration into the stud) at 300mm centres and reduced to 200mm centres at external corners. Boarding should commence at one end fixed vertically and across the partition. The boards should be trimmed to fit accurately to abutments and the head and base, and should be tightly butted together over the centre of the stud faces. The outer layer of boards should be staggered and screw-fixed to the frame vertically with Knauf Self Drilling or Jackpoint Self Drilling Screws.

Knauf Performance Plus is used for the outer layer in areas of high humidity, such as bathroom and kitchen areas.

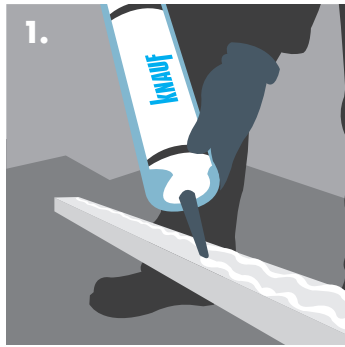

1. Applying two continuous beads of Knauf Sealant to perimeter framing.



2. Fixing Knauf 'U' Channel to form the partition frame.

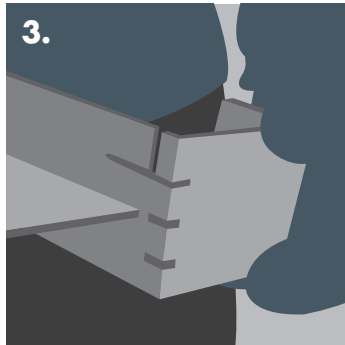

3. A Knauf Staggered Stud Clip is fixed to the Knauf 'I' Stud.

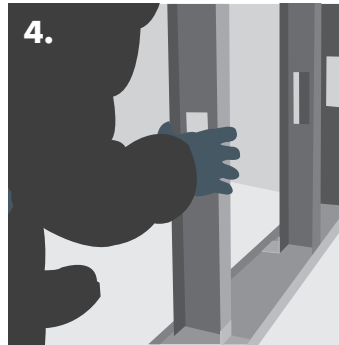

4. Twisting Knauf 'I' Studs into position.



5. Inserting Knauf insulation quilt between the Knauf 'C' or 'I' Studs.



6. Fixing Knauf Soundshield Plus to the frame.



7. Taping and jointing for a seamless finish.

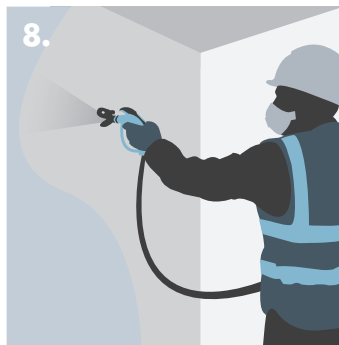

8. Finishing using Knauf plaster.

